

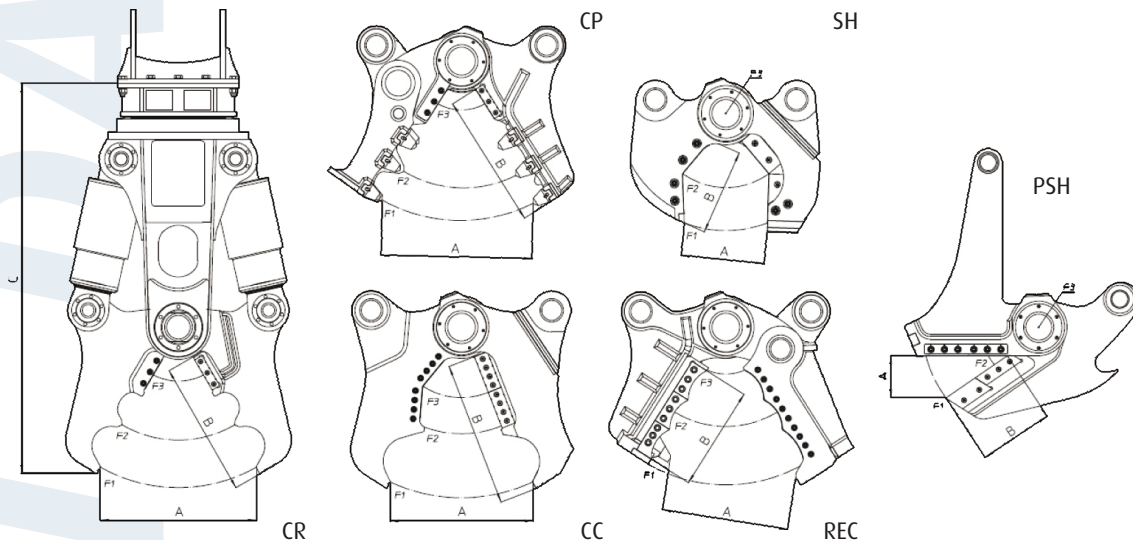

Multisystem

MS20R - MS30R - MS40R - MS60R



DIMENSIONS

		MS20R (mm)	MS30R (mm)	MS40R (mm)	MS60R (mm)
Jaw opening CR	A	820	900	1.200	1.705
Jaw opening CP		730	875	950	1.250
Jaw opening SH		445	485	620	875
Jaw opening CC		700	825	1.075	1.385
Jaw opening PSH		225	225	285	400
Jaw opening REC		550	730	-	-
Jaw depth CR	B	660	785	1.015	1.160
Jaw depth CP		620	780	850	905
Jaw depth SH		480	510	685	790
Jaw depth CC		670	840	1.030	1.120
Jaw depth PSH		375	375	465	730
Jaw depth REC		360	635	-	-
Height with CR jaws	C	2.060	2.240	3.045	3.255
Height with CP jaws		2.020	2.260	2.950	3.095
Height with SH jaws		1.990	2.070	2.845	3.165
Height with CC jaws		2.100	2.220	3.070	3.355
Height with PSH jaws		2.085	2.160	2.705	3.090
Height with REC jaws		2.000	2.310	-	-
Width of CP jaws	L	390	390	480	800
Width of REC jaws		250	425	-	-

CUTTING TABLE WITH SH JAWS (TESTED ON S152)

	MS20R	MS30R	MS40R	MS60R
● Rod	55	60	80	90
○ Tube	N.D.	N.D.	N.D.	N.D.
H IPE	250	330	450	500
H HEA	160	200	320	320
— Plate	12	14	18	20
L L-Profile	N.D.	N.D.	150 x 18	200 x 24

CUTTING TABLE WITH PSH PLATESHEAR (TESTES ON S152)

Tickness	MS20R	MS30R	MS40R	MS60R
	15	20	25	30



TECHNICAL BULLETIN

			MS20R	MS30R	MS40R	MS60R
Excavator weight (bucket place)		t	18-25	25-35	35-50	50-75
Excavator weight (stick place)		t	12-18	15-24	24-30	30-50
Cylinder force		t	110	145	215	247
Weight with kit CR*	CR	kg	2.250	2.750	4.550	6.500
Force at upper tips - F1		t	81	96	136	151
Force in the middle - F2		t	114	138	191	224
Cutting force - F3		t	218	285	400	430
Blade length		mm	175	200	250	300
Weight with kit CP*	CP	kg	2.300	2.900	4.650	7.000
Force at upper tips - F1		t	86	90	146	176
Force in the middle - F2		t	105	142	200	297
Cutting force - F3		t	227	266	400	571
Blade length		mm	140	200	250	220
Weight with kit SH*	SH	kg	2.250	2.850	4.550	6.600
Force at upper tips - F1		t	80	95	142	166
Force in the middle - F2		t	201	232	352	417
Cutting force - F3		t	625	750	1.250	1.400
Blade length		mm	208	245	355	416
Weight with kit CC*	CC	kg	2.300	2.900	4.700	6.600
Force at upper tips - F1		t	73	87	131	138
Force in the middle - F2		t	127	157	256	286
Cutting force - F3		t	207	275	467	507
Blade length		mm	360	440	580	600
Weight with kit PSH*	PSH	kg	2.150	2.650	4.300	6.000
Force at upper tips - F1		t	60	100	160	185
Blade force - F2		t	85	150	240	295
Force at pin - F3		t	625	750	1.250	1.400
Weight with kit REC*	REC	kg	2.300	3.100	-	-
Force at upper tips - F1		t	85	91	-	-
Blade force - F2		t	129	133	-	-
Force at pin - F3		t	253	279	-	-
Hydraulic working pressure	bar		32-350	320-350	320-350	320-350
Oil flow	l/min.		150-200	200-250	250-300	280-320
Rotation type	-		360° hydraulic	360° hydraulic	360° hydraulic	360° hydraulic
Max. oil pressure hydraulic motor	bar		90-100	90-100	100-115	100-115
Oil flow hydraulic motor	l/min.		30-40	30-40	30-40	30-40
Closing time at max. oil flow	sec.		2,49	2,94	4,34	5,30
Opening time at max. oil flow	sec.		2,60	2,44	4,16	6,63
N° of cycles per minute at max. oil flow	cycles/min.		11,8	11,1	7,1	5
N° of revs per minute at max. oil flow	revs/min.		8,3	8,1	6,7	5,7
Hydr. ports size cylinder	-		3/4" SAE 6000 p.s.i	1" SAE 6000 p.s.i.	1 1/4" SAE 6000 p.s.i.	1 1/4" SAE 6000 p.s.i.
Hydr. ports size rotation	-		1/2" GAS	1/2" GAS	1/4" GAS	1/4" GAS
Hydr. ports size drain line	-		Not needed. Refers to drain hydraulic rotation	Not needed. Refers to drain hydraulic rotation	1/4" GAS	1/4" GAS
Speed valve	-		Yes	Yes	Yes	Yes
Interchangeable wear parts	-		Yes	Yes	Yes	Yes
Automatic grease system	-		No	No	No	No

* Tool weight does include connection.

- Interchangeable teeth are only available for the pulveriser jawset
- MS20-MS30 are with bolted coupler.
- MS40-MS60 are with welded coupler.

The noted performances have been achieved by the maximum pression and capacity values.
Technical data may change without prior notice.

- CR = Crusher jawset
- CP = Pulveriser jawset
- SH = Shear jawset
- CC = Combi jawset
- PSH = Plateshear jawset
- REC = Recycling jawset